



A/V & Conference Services



Classroom



Rounds



Theater

*Images are for demonstrating set-up style only.

RHODODENDRON

ROOMS	ROOM SIZE	CLASSROOM	ROUNDS	THEATER
1 A-C	96'x51'	145	200	320
1 A	51'x28'	54	56	80
1 B	51'x38'	66	120	200
1 C	51'x30'	36	40	60
2 A-B	35'x23'	24	48	50
2 A-B (each)	23'x17'	12	16	24
3 A-B	52'x35'	72	120	150
3 A-B (each)	35'x26'	36	48	72
4	28'x24'	Fixed		

Numbers shown are maximum occupancy per space.

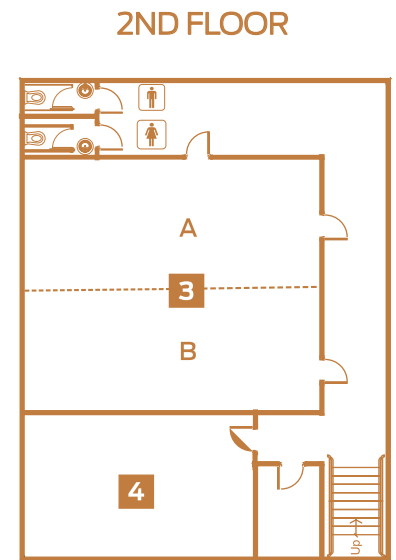
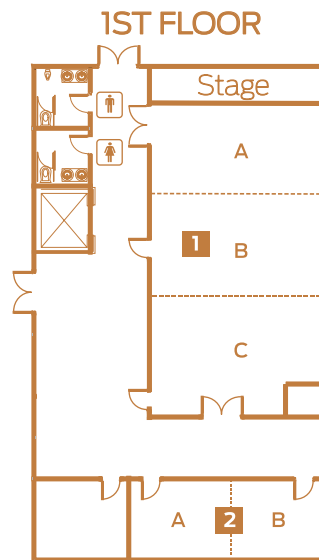

NOTE: Initial room set-up is free. Each subsequent room change is \$100 (+15% service charge).

Audio-Visual Equipment Rentals			
prices are per day and do not include 15% service charge			
Item	Price	Item	Price
PODIUM	N/C	CD PLAYER (DECK)	\$15
EXTENSION CORD	N/C	FLIPCHART W/ EASEL AND MARKERS	\$15
WHITEBOARD WITH MARKERS	N/C	DVD	\$20
PROJECTION SCREEN	\$5	TV	\$20
WIRED MIC WITH STAND & CABLE**	\$10	VIDEO PROJECTOR W/SCREEN	\$80

**Conference space is equipped with 1 wired mic and stand.